

Installation Instruction

MODELS: D701 / D702

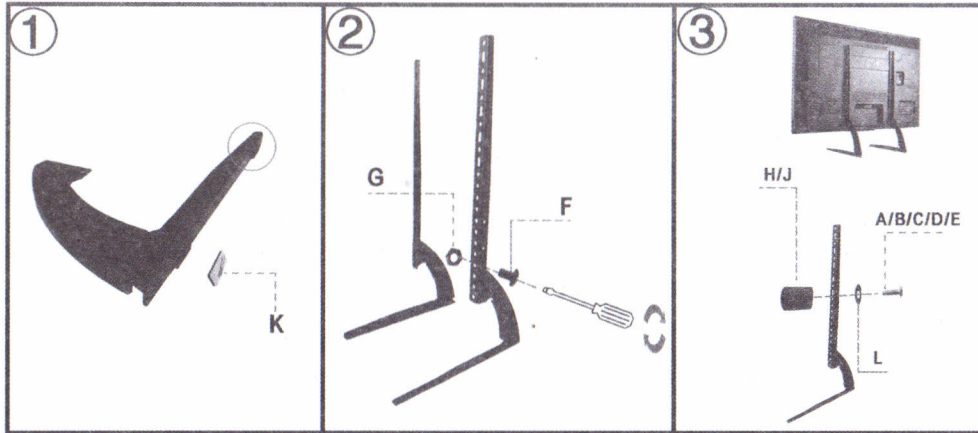

A Metal screw M4*16*4	B Metal screw M5*16*4	C Metal screw M6*16*4	D Metal screw M6*35*4	E Metal screw M8*20*4
F Metal screw M6*10*4	G Metal Nut M6*4	H Nylon gasket thickness 20mm*4	J Nylon gasket thickness 5mm*4	K Foam antiskid pad 15*40mm*4
L Metal gasket 6*1*4	M Metal gasket 6*1*4	N Metal gasket 6*1*4		

Two Styles

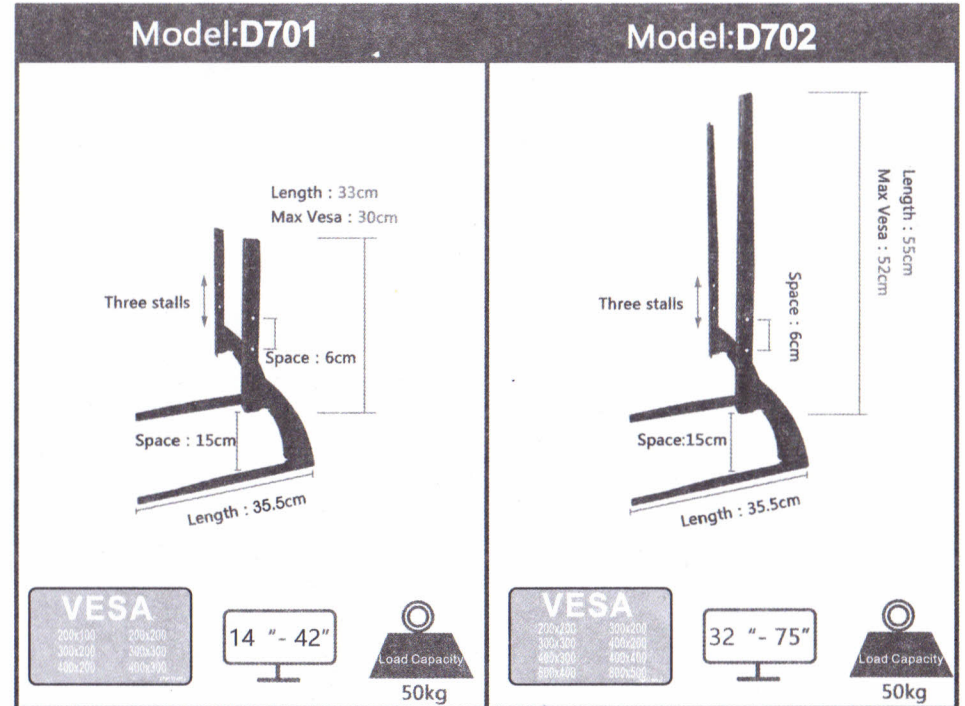

Warm Tips

The product is manufactured according to the enterprise standard. We provide a variety of screws suitable for most TV sets for each bracket. Note: If you encounter a situation where the screws we have shipped are not suitable, You need to go to the store to repurchase the configuration screws. Please understand!